



10 Thatcher Street Wauchope NSW

3 1 2

Available for 12+ months lease. Charming well-presented family home on corner block of Thatcher St and Wade St. Suitable for couples and small families. Single level layout, 3 to 5 steps lead into the front and back door. Located in a quiet street, close to town centre. Open plan living, dining and kitchen. Aircon and wood fire in lounge room. Aircon in master bedroom + ceiling fans in all bedrooms. All bedrooms with built-in robes. Two carports, one with electric roller door. Fully fenced backyard with workshop and shed.

Saw mill relicts decorate the garden beds and workshop depicting Wauchope's timber trade history. The old saw mill directly across the road is no longer and is now a bus depot.

Highlights:

- Open plan living and dining area with tiled floor and wood

Building Size : 10 sqm

View

: <https://www.beachscape.com.au/lease/nsw/mid-north-coast/wauchope/residential/house/7588057>



Susan De Jonge
0410 938 691



Hayley Hayes
0428524484

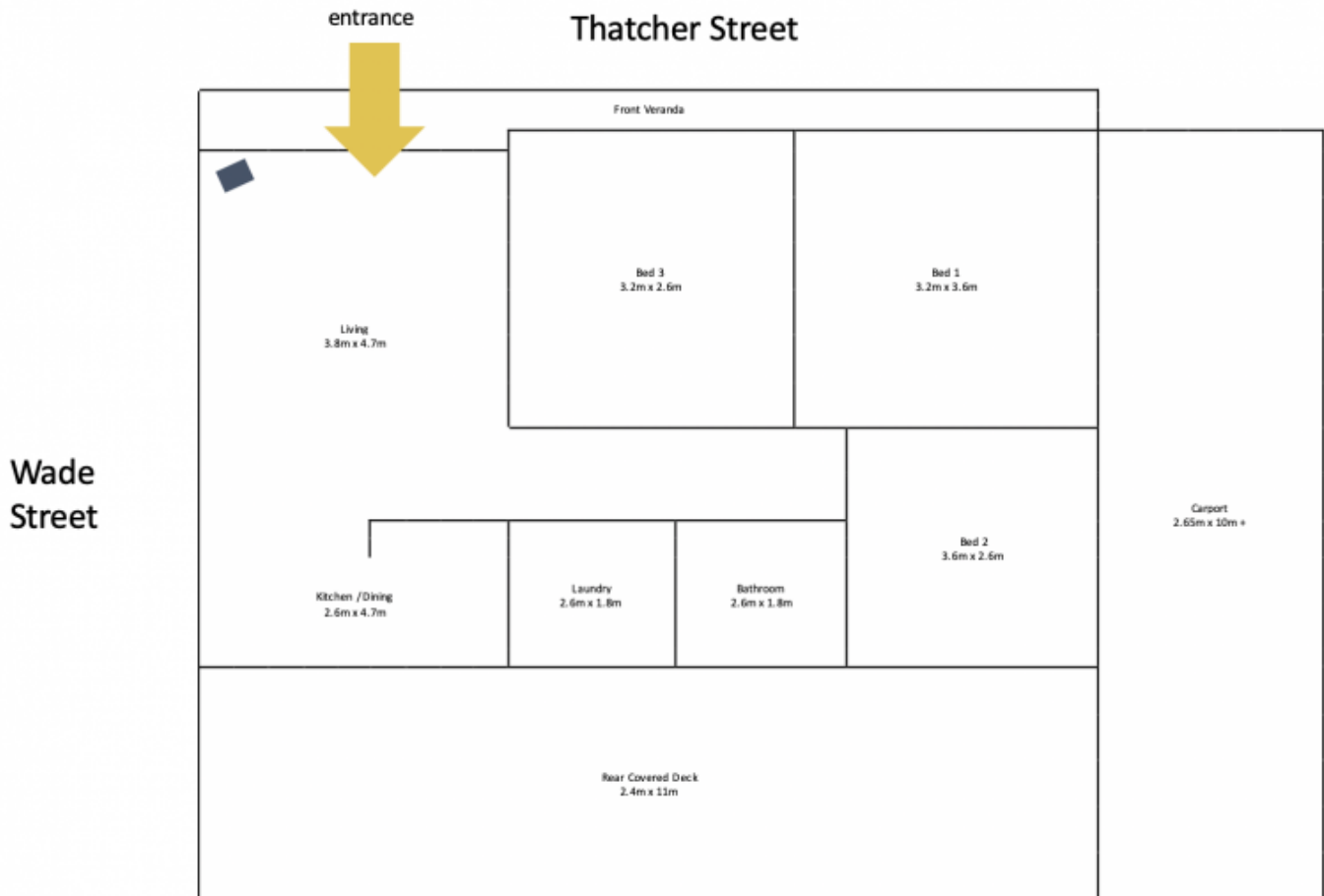

Floorplan 10 Thatcher Street, Wauchope

Disclaimer: floorplan not true to size, for indicative purposes only